



PORTO WALK

AUGUST 2019

Welcome To

YOUR JOYOUS AXIS

PORTO WALK





DISCLAIMER

- The information contained in this promotional material is for illustration purposes only and is subject to change. Statements, figures, calculations, plans, images and representations are indicative only.
- Images may include sketches, artist impressions and computer generated images.
- Changes may be made during the further planning or development stages of any development and dimensions, fittings, finishes, ongoing costs and specifications and representations are subject to change without notice.
- The information contained in this material is a guide only and does not constitute an offer, inducement, representation, warranty or contract.
- No part of it should be reproduced, adapted or communicated without the written consent of the copyright owner.

GOLF PORTO MARINA STRATEGIC LOCATION

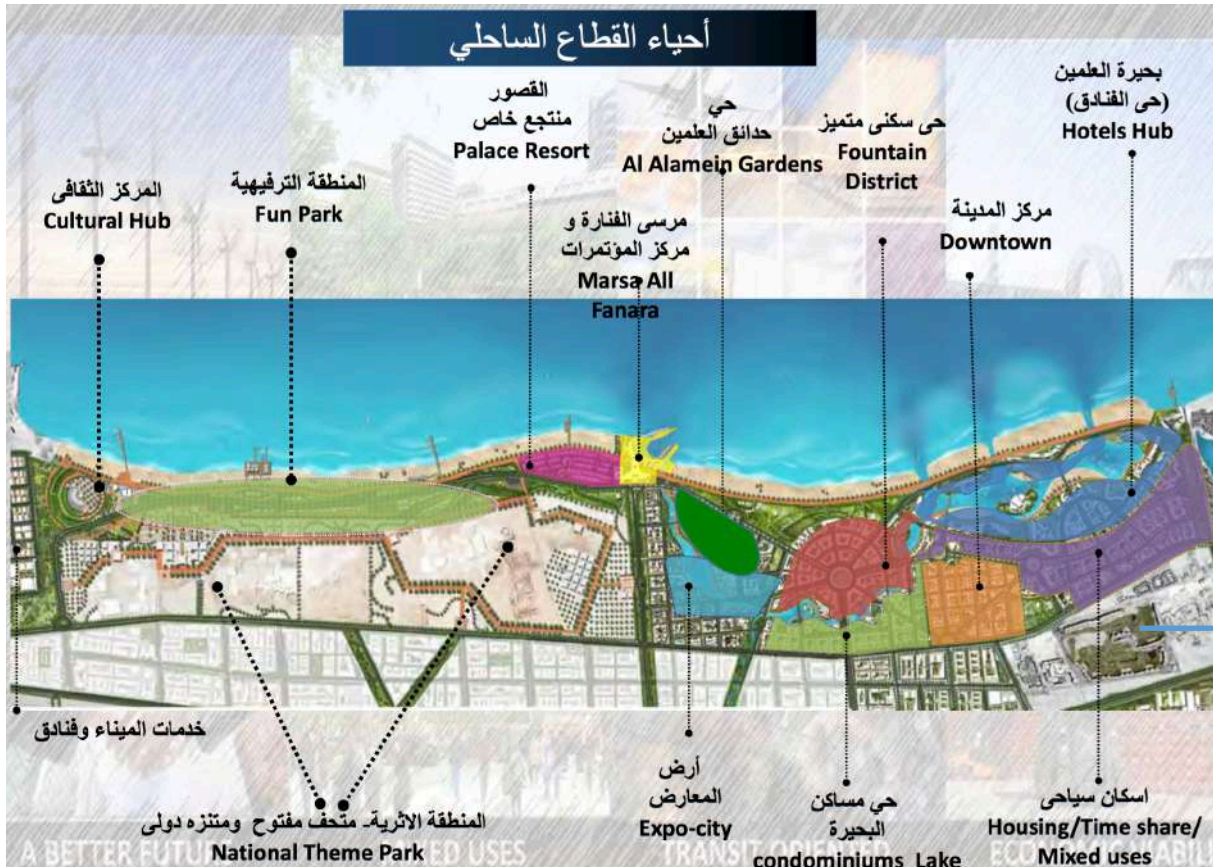

In the midst of the North Coast, next to El-Alamein New City, lies "Golf Porto Marina".

"Golf Porto Marina" is the new North Coast hub strategically located between all attractions.

Golf Porto
Marina



YOUR ULTIMATE LIVING EXPERIENCE

In a very strategic location, sets PORTO WALK in the heart of Golf Porto Marina.



LOCATION ON MASTER PLAN



MODERN ARCHITECTURE



AQUA PARK & LODGING GOLF P. MARINA



WATER SPORTS

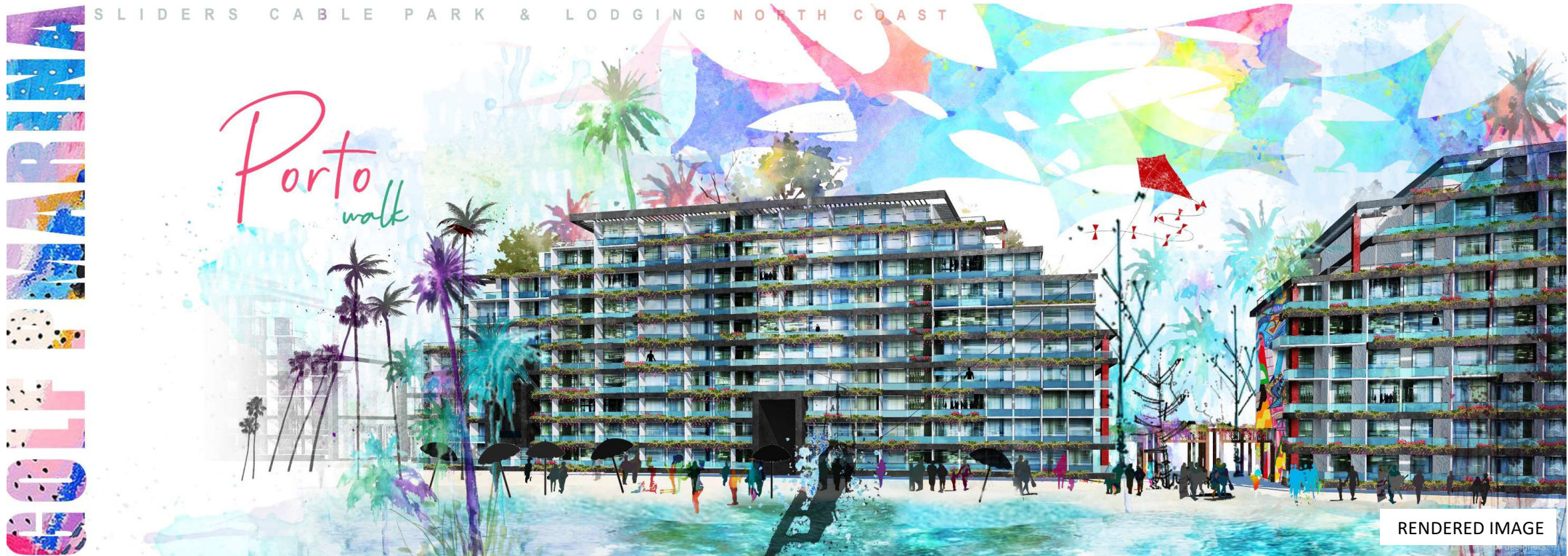



LIVE IMAGE

OWN YOUR UNIT

FACTS ABOUT GOLF PORTO MARINA

- 1.8 Million SQM Development
- Aqua Porto
- Swimming Pools
- 1KM Promenade
- Cafés and Restaurants
- Sports Facilities
- Life Entertainment
- Hotel Serviced Apartments



FACILITIES



CIRCUS



HORSEBACK
RIDING



SWIMMING
POOLS



AQUA PORTO



GO-KARTING



PAINT-BALL



GOLF COURSE



CAFES &
RESTAURANTS



HOTEL SERVICED
APARTMENTS

Golf Porto
Marina



INTERNATIONAL CARNIVALS

All year around International Carnivals are one of the main signatures of Golf Porto Marina.

PORTO WALK overlooks all of this hype and in the middle of all festive energy happening in Golf Porto Marina.



FACILITIES

GOLF PORTO MARINA



LIVE IMAGES

FLOOR PLAN – GROUND FLOOR

P O R T O W A L K - G O L F P O R T O M A R I N A



G. FLOOR PLAN

FLOOR PLAN – 1st & 2nd

P O R T O W A L K - G O L F P O R T O M A R I N A



1st & 2nd FLOOR PLAN

FLOOR PLAN – 3rd – 4th – 5th & 6th

PORTO WALK - GOLF PORTO MARINA



- 2 Bedroom unit (88 m²)
- 1 Bedroom corner front unit (66 m² Indoor, 17 m² outdoor)
- 1 Bedroom corner rear unit (59 m² Indoor, 7 m² outdoor)
- 1 Bedroom unit (59 m²)
- Studio unit (30 m²)
- Terraces

FLOORS 3, 4, 5, 6
TYPICAL FLOOR PLAN

FLOOR PLAN – 7th

P O R T O W A L K - G O L F P O R T O M A R I N A



- 2 Bedroom unit (88 m²)
- 1 Bedroom corner front unit (59 m² + 53 m² sky open terrace)
- 1 Bedroom corner rear unit (59 m² + 37 m² sky open terrace)
- 1 Bedroom unit (59 m²)
- Studio unit (30 m²)
- Terraces

7th FLOOR PLAN

FLOOR PLAN – 8th

P O R T O W A L K - G O L F P O R T O M A R I N A



8th FLOOR PLAN

UNITS' PLAN

1 BEDROOM CORNER FRONT
66m² indoor+ 17m² outdoor



- ① lobby
- ② Reception
- ③ kitchen
- ④ toilet
- ⑤ bedroom
- ⑥ terrace

1 BEDROOM CORNER REAR
59m²+ 7m² corner terrace



1 BEDROOM CORNER FRONT
59m²+ 53m² sky open terrace



1 BEDROOM CORNER REAR
59m²+ 37m² sky open terrace



Porto Walk





YOUR NEW LIFE IN SAHEL







Thank You

 **19106**
www.amer-group.com



Visit our Showroom next to the Hotel

